

SABRENT
Connecting Differently™



WIRELESS RECHARGEABLE MOUSE
WITH 4D FUNCTION

FEATURES

- Advanced high precision optical sensor
- Ergonomic design for a high-level of comfort
- Multifunction wheel for scroll and zoom
- Optical mechanical design for precise tracking on almost any flat surface
- Multimedia mode enabled by holding down the DPI key for 6 seconds
- Quick access to Windows 8 start screen
- Tilt-button, convenient to browse
- High precision optical engine
- 300mAh Li-battery
- Resolution: 800/1600 DPI adjustable

QUICK INSTALLATION

- 1 Get the receiver
- 2 Connect the receiver to an available USB port on your computer

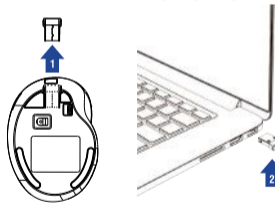

RECHARGE

- 1 Connect the micro USB cable to the mouse
- 2 Connect the other end of the USB cable to your computer
- 3 When charging, blue light will be on
- 4 Charge the mouse for about 2 hours
Note: Mouse is fully charged when the blue light turns off

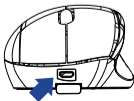

SWITCH BETWEEN STANDARD AND MULTI-MEDIA MODE

Hold down button **2** for **6** seconds to switch
Please review below the button setup corresponding to each mode

BUTTON/MODE	STANDARD MODE	MULTI MEDIA MODE
BUTTON 1	Windows button	Next Song
BUTTON 2	DPI button	Pause/Play Music
BUTTON 3	Switch to left/right in Excel	Volume Up/Down

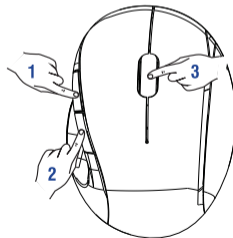

FCC STATEMENT:

This device complies with Part 15 of the FCC Rules. Operation is subject to the following two conditions:

- (1) This device may not cause harmful interference, and
- (2) This device must accept any interference received, including interference that may cause undesired operation.

Warning: Changes or modifications not expressly approved by the party responsible for compliance could void the user's authority to operate the equipment.

NOTE: This equipment has been tested and found to comply with the limits for a Class B digital device, pursuant to Part 15 of the FCC Rules. These limits are designed to provide reasonable protection against harmful interference in a residential installation. This equipment generates uses and can radiate radio frequency energy and, if not installed and used in accordance with the instructions, may cause harmful interference to radio communications. However, there is no guarantee that interference will not occur in a particular installation. If this equipment does cause harmful interference to radio or television reception, which can be determined by turning the equipment off and on, the user is encouraged to try to correct the interference by one or more of the following measures:

- Reorient or relocate the receiving antenna.
- Increase the separation between the equipment and receiver.
- Connect the equipment into an outlet on a circuit different from that to which the receiver is connected.
- Consult the dealer or an experienced radio/TV technician for help.