

MODEL: DS-SC5B



5-BAY 3.5" SATA HARD DRIVE TRAY-LESS DOCKING STATION (USB 3.1 GEN 2)



WINDOWS / MAC OS / LINUX

QUICK INSTALLATION GUIDE

FEATURES

- USB 3.1 Gen 2 Type-C port with up to 10Gbps transfer speed.
- 5 x SATA 6Gbit/s 3.5" hard drive bays.
- High-quality aluminum for optimal heat dissipation and structural integrity.
- Hot-Swappable with 5 independent ON/OFF power switches.
- Locking key to prevent accidental bay opening, fully tray-less design.
- Additional USB Type-C rear port allows you to connect other USB devices, or to daisy-chain another multi-drive docking station.
- Built-in 120mm fan for additional cooling power.
- Built-in Kensington security slot.
- Auto-Switching internal power supply: 100 to 240 volts.
- Main ON/OFF power switch.
- Fully backward compatible with USB 3.0 / 2.0 / 1.1.
- NOTE: This multi-bay station does NOT do RAID arrays on its own.

SYSTEM REQUIREMENTS

- Windows / Mac OS / Linux

PACKAGE CONTENTS

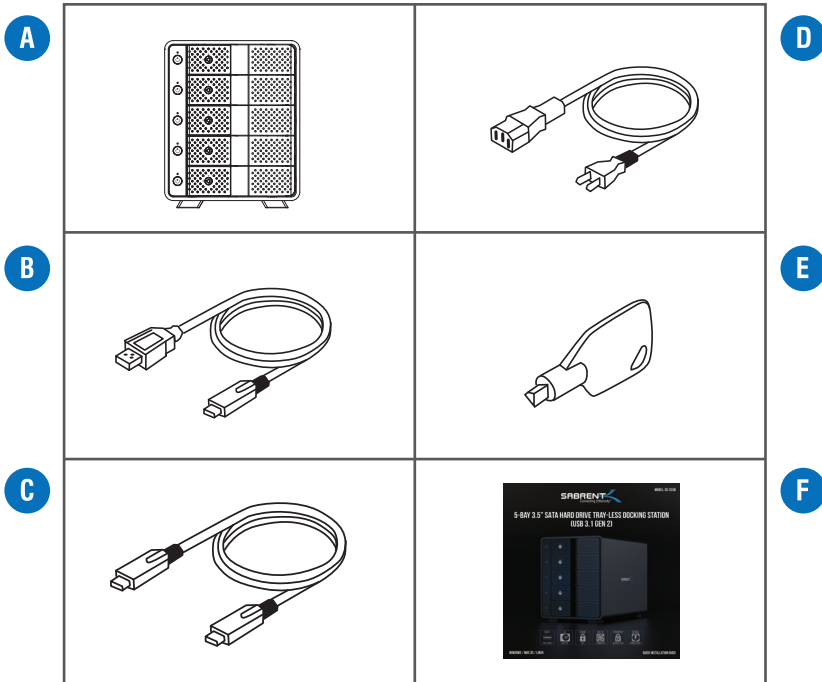

- A.** Sabrent 5-bay Hard-Drive tray-less docking station
- B.** USB Type-C to Type-A cable
- C.** USB Type-C to Type-C cable.

- D.** Power cable.
- E.** Locking Key
- F.** This quick installation guide

FRONT PANEL DETAIL

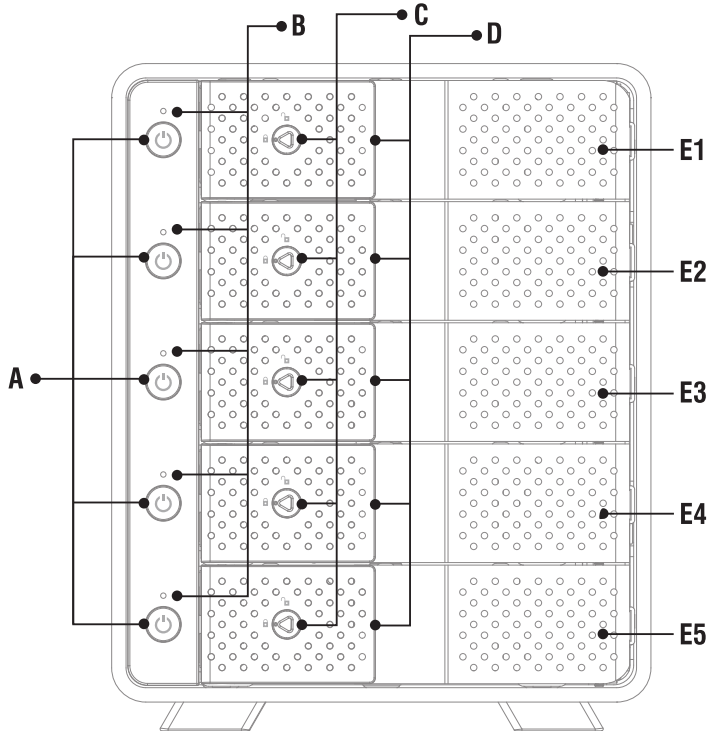

- A.** Independent Power Switch
- B.** Status LED
- C.** Door Lock

- D.** Door Handle
- E.** Hard Drive Slot

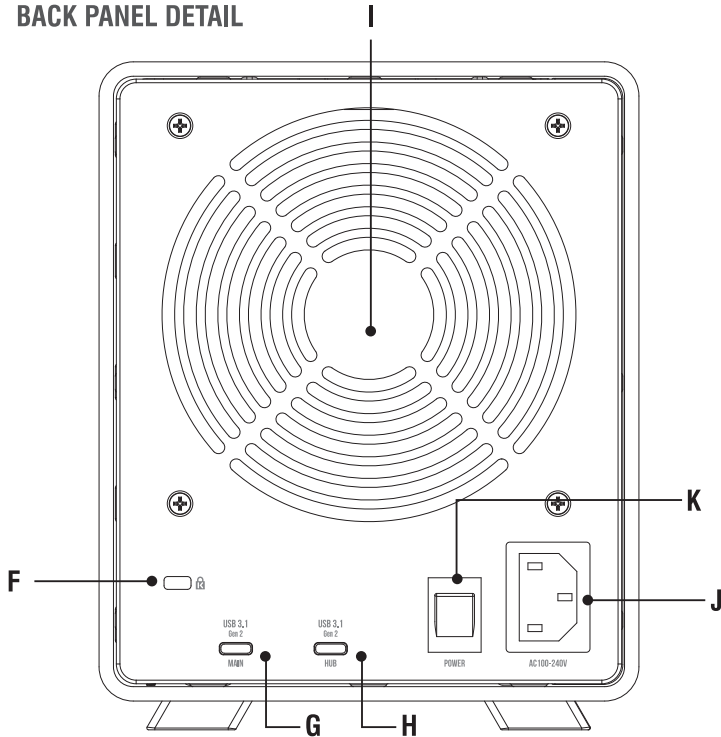
BACK PANEL DETAIL

- F.** Kensington Security Lock slot.
- G.** USB Type-C 3.1 Generation 2 port – Connect to computer.
- H.** USB 3.1 Generation 2 Hub – Connect to any USB peripherals.

- I.** 120mm cooling fan.
- J.** Auto-Switching 100~240V AC power input.
- K.** Main power switch.

LED INDICATOR REFERENCE TABLE

ACTIVITY	LED STATUS
Hard Drive inserted and Power ON	BLUE / SOLID
Hard Drive not inserted and Power ON	OFF
Accessing Hard Drive	PINK / FLASHING
Hard Drive Error	OFF
Hard Drive Ejected from PC / PC Power OFF	RED / SOLID
Independent Power ON	OFF
Main Power OFF	OFF

HDD INSTALLATION PROCEDURE

Step 1: Pull the door handle on the front panel to open each individual hard drive bay.

Step 2: Carefully insert hard drive into slot.

Step 3: Close the slot door and make sure it clicks into place. Use the locking key to avoid accidentally opening the bay (optional).

Step 4: Connect the Sabrent docking station to your computer using the USB Type-C cable. Depending on your computer, you can also use the USB Type-A cable. Connect it to MAIN.

Step 5: Connect the power cable from your wall outlet to your docking station's 100~240V AC power input.

Step 6: Turn on the main power switch on the back of the unit. Turn ON / OFF each hard drive individually with the switches on the front panel.

Step 7: (Optional) Connect any USB peripherals to the USB HUB port on the back of the docking station.

NOTE:

- Always use your operating system's EJECT HARD DRIVE function before removing a disk, turning off your docking station, or opening any hard drive bay.
- This multi-bay station does NOT do RAID arrays on its own. You can still do RAID arrays via software. For instance, using Microsoft Storage Spaces.



WWW.SABRENT.COM