

5-BAY USB-C DOCKING STATION FOR 2.5" SATA HDDs AND SSDs (up to 15mm)



WITH BUILT-IN COOLING FAN

FEATURES

- Expand your storage space easily and reliably. Read and write up to five 2.5" SATA HDDs or SSDs simultaneously over a USB 3.2 Gen 2x1 (10Gbps) USB-C host connection.
- Get a stable and reliable USB connection on systems that lack sufficient power over USB and/or have limited internal SATA ports.
- Hot-swappable and plug & play. Supports 2.5" SATA HDDs and SSDs up to SATA III (6Gbps) and 15mm height for maximum compatibility.
- An independent, 80mm cooling fan can be switched on and off as desired to keep your drives cool or your environment quiet.
- Tool-free installation with fast and convenient drive bay access. Individual power LEDs clearly indicate drive bay status.

OPERATING SYSTEM REQUIREMENT

- Windows
- macOS
- Linux



1

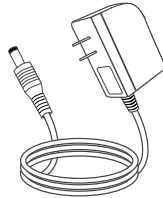

2

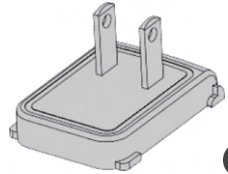

3

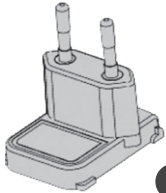

4

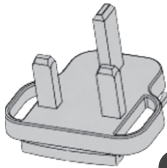

5

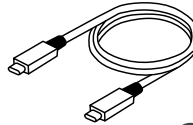

6

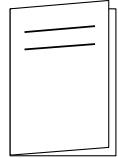

7

PACKAGE CONTENTS

1. 5-Bay USB-C Docking Station
2. Power adapter (12V/3A)
3. US plug adapter
4. Type C plug adaptor for Europe and South America

5. UK plug adapter
6. USB Type-C cable (100cm)
7. User manual

CONNECTION DIAGRAM

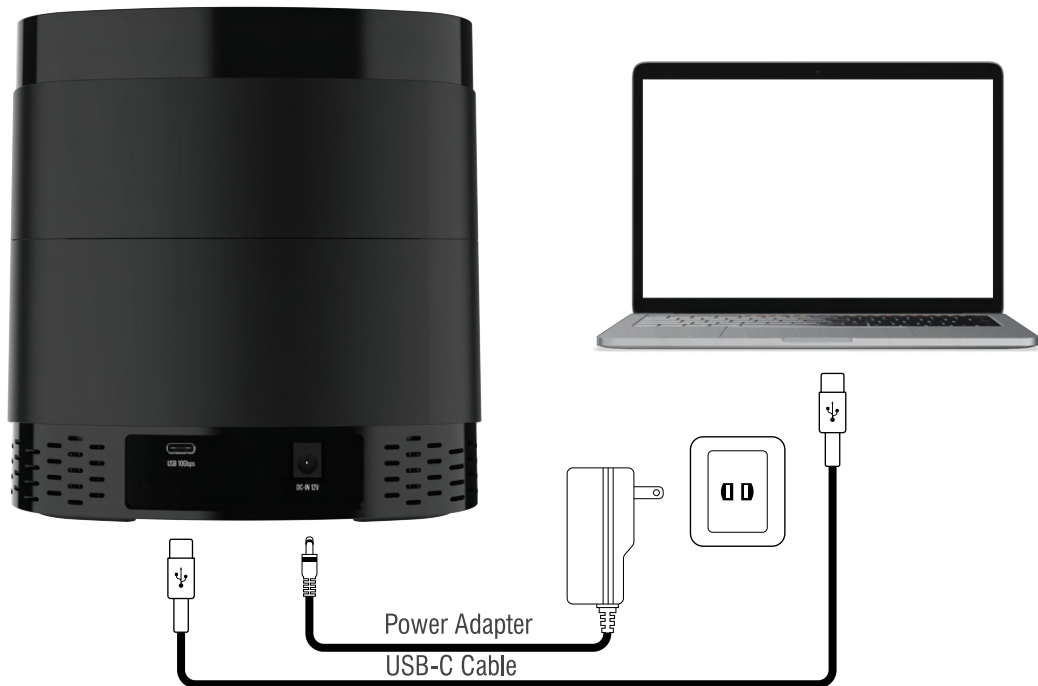

LED STATUS INDICATORS

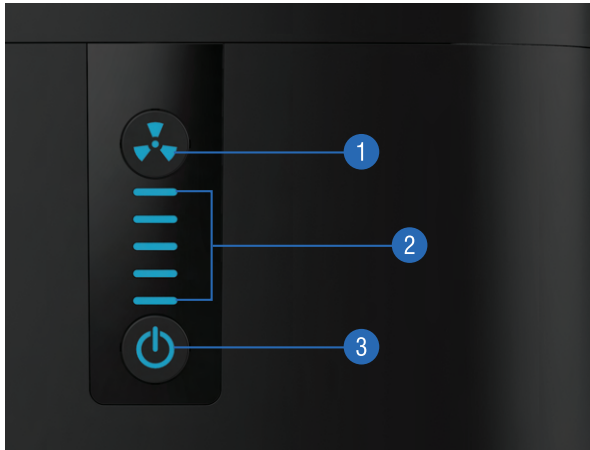

#	COLOR	FUNCTION
1	BLUE	FAN POWERED ON
2	BLUE/FLASHING	DRIVE BAY POWERED ON/ACTIVITY
3	BLUE	DEVICE POWERED ON

FRONT AND REAR VIEWS

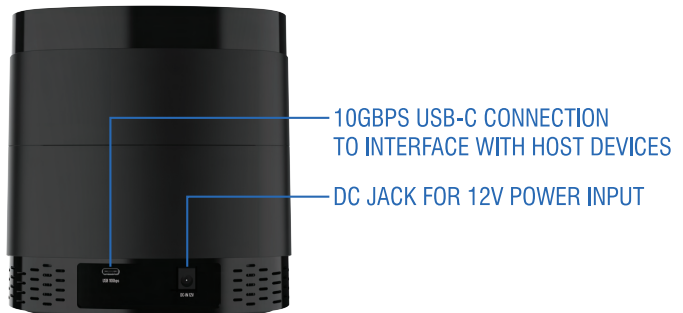
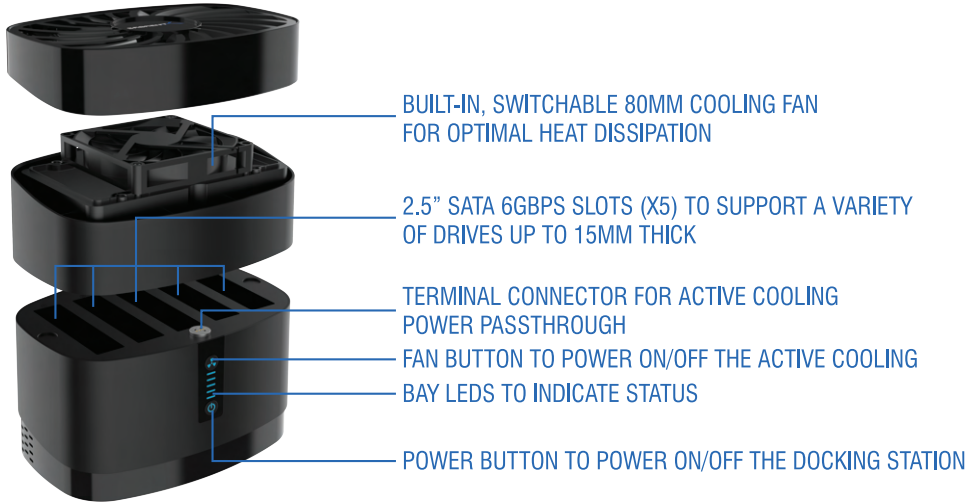

DEVICE SETUP AND DRIVE INSTALLATION

1

STEP 1

Open the docking station by lifting the magnetic lid straight up.

2

**BE CAREFUL WITH THE DIRECTION
OF THE DRIVE'S SATA PORT**

STEP 2

Carefully insert each drive so that it is properly connected to the SATA connector at the bottom of each bay (Note the direction of the SATA ports to avoid damaging the connector upon insertion. Drives can only go in one way.).

3

A

B

C

STEP 3

A. Place back the magnetic lid to close the docking station.

B. As per the connection diagram, plug the DC power adapter cable end into the power input on the back of the device and the brick into a power outlet. Plug the USB cable into the device and the other end into a compatible USB port on the host.

C. Use the front Power button to turn the device on and the fan button to turn on the built-in cooling fan (An audible beep will sound when connected to the host.).

4 Management

Action View Help

Volume	Layout	Type	File System	Status
(Disk 0 partition 1)	Simple	Basic		Healthy (EFI System Partition)
(Disk 0 partition 4)	Simple	Basic		Healthy (Recovery Partition)
64 GB micro (D:)	Simple	Basic	NTFS	Healthy (Primary Partition)
OSDisk (C:)	Simple	Basic	NTFS (BitLo...	Healthy (Boot, Page File, Crash Dump, Primary...

Disk 0	OSDisk (C:)	
Basic 238.35 GB Online	499 MB Healthy (EFI System Partition)	237.37 GB NTFS (BitLocker Encrypted) Healthy (Boot, Page File, Crash Dump, Primary Partit

Disk 1	64 GB micro (D:)	
Removable 59.48 GB Online	16 MB Unallocated	59.46 GB NTFS Healthy (Primary Partition)

A

Disk Utility

View Volume First Aid Partition Erase

Internal

Macintosh HD **volumes**

- Macintosh-Data
- Special Projects

External

- Backup Disk

Disk Images

- Billing

Macintosh HD
APFS Volume Group • APFS
macOS 13.0 (22A297)

Used: 177.11 GB Other Volumes: 8.1 GB

Mount Point (Read-Only):	Type:	Capacity:	Owners:
/		494.38 GB	
Available:		309.17 GB	Connection:
Used:		177.11 GB	Device:

Snapshot Name: com.apple.os.update-A34DFE189... Snapshot UUID: A2AD8... **B**

STEP 4

If you are using brand new, unused drives, please open Disk Management (Windows) (A) or Disk Utility (macOS) (B), or your preferred partition manager to format and mount them for use.

TROUBLESHOOTING

My Computer Will Not Recognize My Docking Station:

- Make sure the USB cable is properly connected to your docking station and computer.
- Try connecting the docking station to a different USB port on your computer or laptop.
It may take up to 60 seconds for the computer to recognize the docking station.
- Make sure you have the most recent updates for your operating system.
- Make sure your power outlet is working.
- Plug your USB device directly into a USB port on your computer (if plugged into a USB hub).
- If your computer still does not recognize the device, please contact Sabrent support.

Connection Is Slow:

Make sure the docking station is connected directly to a USB 3.2 port on your computer. Do not use a USB hub. While the docking station is backward compatible, when connected to a USB 2.0 or 1.1 port, the docking station will operate at much slower speed.

Power Issues:

Try the power adapter on a different power outlet. Make sure that the power adapter is securely connected to the docking station.

Docking Station Disconnects From Computer:

Make sure the USB cable is securely connected to your docking station and computer. Connect the power adapter to the docking station and a working power outlet. Try connecting the docking station to a different USB port on your computer. Check your computer's sleep or standby settings.



FOR HELP, COMMENTS, QUESTIONS OR CONCERNS
PLEASE CONTACT OUR TECH SUPPORT TEAM VIA OUR WEBSITE

WWW.SABRENT.COM