



10GbE INTERNAL PCIe NETWORK ADAPTER



**WINDOWS
OS**
COMPATIBLE

**MAC
OS**
COMPATIBLE

**LINUX
OS**
COMPATIBLE

ETHERNET

NT-10PE USER MANUAL

FEATURES

- Network connection speeds of up to 10Gbps (10GbE) via a PCIe slot
- Backward compatible with 5GbE/2.5GbE multi-gig connections, 1GbE, Fast Ethernet (100Mbps), and Ethernet (10Mbps)
- PCIe 3.0 x4 physically and electrically, also compatible with x8/16 physical and x1/x4/x8/x16 electrical slots of any generation
- Feature support for L0s/L1/L23/L3, S3/S4 wake-up, LTR/AER, upstream/downstream SRTS, 512B payload size, and more
- Aluminum alloy construction with integrated status LEDs



SUPPORTED OPERATING SYSTEMS

- Windows
- macOS
- Linux

PACKAGE CONTENTS

- 10GbE Internal PCIe Network Adapter

PCIe COMPATIBILITY

x16		✓
x8		✓
x4		✓
x1		✗

PRODUCT OVERVIEW

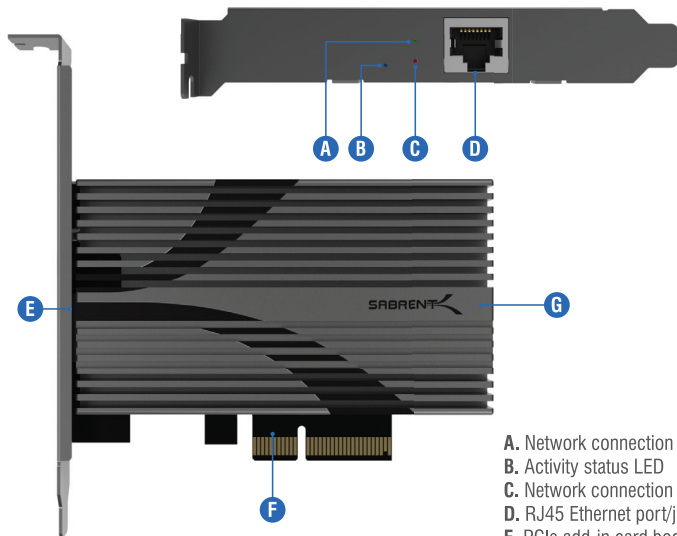

- A. Network connection status LED, 10GbE
- B. Activity status LED
- C. Network connection status LED, <10GbE
- D. RJ45 Ethernet port/jack
- E. PCIe add-in card body
- F. PCIe 3.0 x4 connector
- G. Aluminum alloy heatsink

LED STATUS INDICATORS

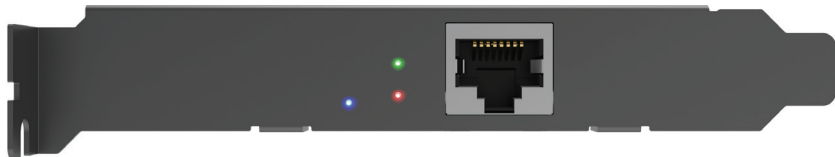

LED ID	COLOR	INDICATION
Network Status LED #1	Green	10GbE Connection
Network Status LED #2	Red	5G/2.5G/1G/100M/10M Connection
Activity Status LED	Blue	Network Data Transmission

GETTING STARTED

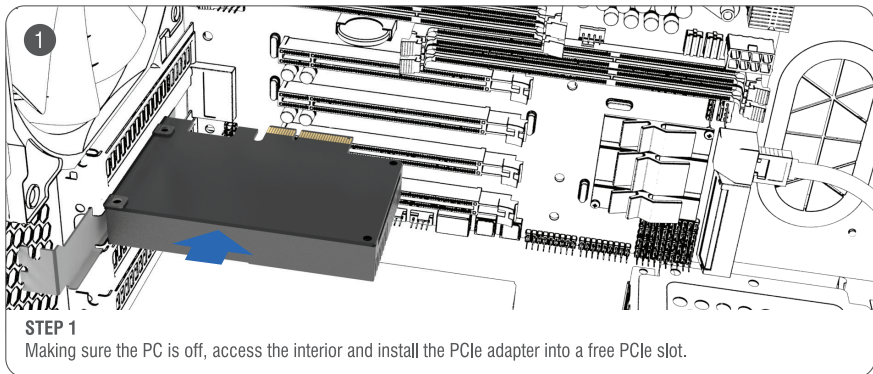

2

STEP 2

Install any necessary drivers for the system and adapter. Scan the QR code or visit our website at www.sabrent.com for the download.



**Note: Public drivers available from hardware provider Marvell (AQC113) here:
www.marvell.com/support/downloads.html**

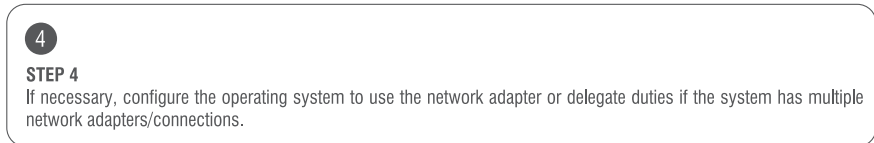
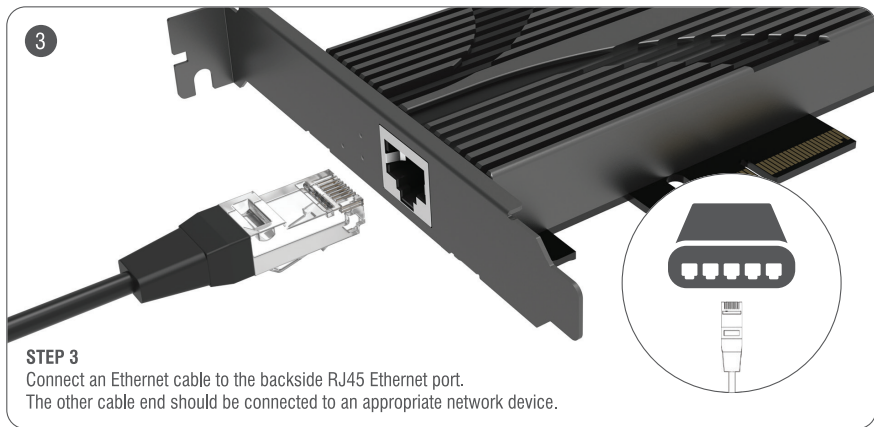

FREQUENTLY ASKED QUESTIONS

Q. With what PCIe slots does this adapter work?

A. This adapter will work in a range of PCIe slots but is designed for an x4 or larger (x8/x16) physical PCIe slot. For the best performance, the slot must be x4 or wider electrically, although x1 will work. Some systems may require UEFI configuration, including PCIe bifurcation in some cases, for specific slots to operate properly.

Q. How can the maximum performance of the adapter be reached?

A. All cables and networking equipment in the network chain must conform to 10GbE standards for maximum performance. This means a CAT6a or newer cable with consideration of cable length. The adapter will fall back or negotiate to a lower speed if conditions are not sufficient.

Q. What operating systems are supported?

A. The adapter is designed for Windows 7+, macOS 10.x+, and various Linux distributions.

Q. What are some of the best use and care practices?

A. It is advised not to bend or put excessive weight on the RJ45 port with an inserted network cable. Avoid adapter contact with water and other liquids. The adapter should be operated in places between 0° and 40°C and from 5% to 90% humidity.



FOR HELP, COMMENTS, QUESTIONS OR CONCERNS
PLEASE CONTACT OUR TECH SUPPORT TEAM VIA OUR WEBSITE

WWW.SABRENT.COM