



USB4 CFexpress TYPE B CARD READER



CR-U4XB USER MANUAL

FEATURES

- Designed for use with CFexpress Type B memory cards
- Supports fast transfer speeds at up to 3.500 MB/s via USB4
- Detachable USB Type-C cable (40Gbps) is included for a range of hosts
- Optionally attachable to a camera or cage for convenient external recording
- Aluminum alloy casing for improved heat dissipation and durability
- Silicone sleeve offers additional environmental protection

SYSTEM REQUIREMENTS

- macOS / iOS / iPadOS / Windows / Linux /
USB On-The-Go (OTG-compatible) smartphones

PACKAGE CONTENTS

- USB4 CFexpress Type B card reader
- USB4 cable (30cm)

PRODUCT OVERVIEW

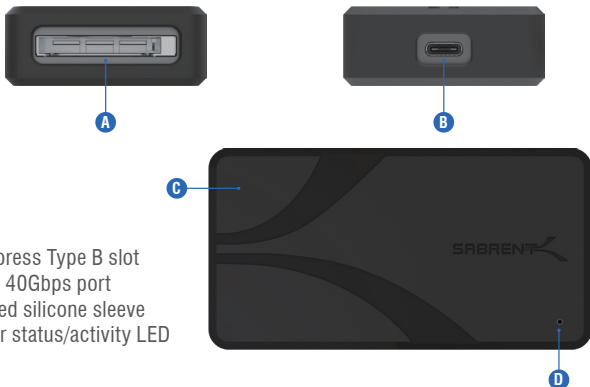

- A. CFexpress Type B slot
- B. USB4 40Gbps port
- C. Rugged silicone sleeve
- D. Power status/activity LED

LED STATUS INDICATORS

LED STATUS	INDICATES
Off	Device is sleeping or lacks power
Solid	Device is powered on
Flashing	Device is active

GETTING STARTED



1. Insert a CFexpress Type B card into the card reader.

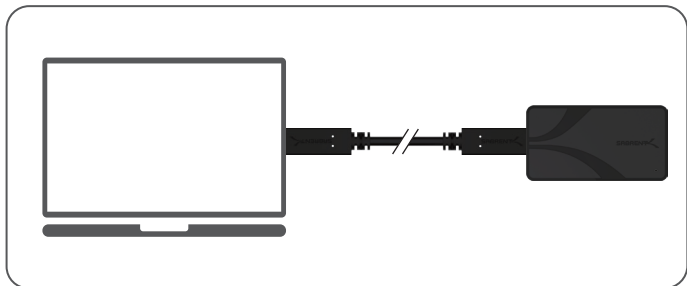

2. Connect the card reader to your device or computer using the included USB4 cable.
3. Begin reading, writing, or copying your files effortlessly.

FREQUENTLY ASKED QUESTIONS

Q. What type of ports are compatible with this card reader?

A. While the card reader is designed for USB4, this technology will work with Thunderbolt ports as well as with older USB ports. Performance is dependent on the host connection speed, the card speed, and your particular hardware configuration. Some Thunderbolt ports may connect at lower than expected USB speeds, so please check your motherboard specifications.

Q. Why doesn't my card reader work/show up? Is this a compatibility problem?

A. Make sure that the USB port and card being used are functional. The card may not show up with a drive letter until properly formatted or assigned. If applicable, update the host's USB controller driver and firmware. If your device's USB4 port has dated firmware, the card reader may not function at full speed or be detected with the included USB4 40Gbps cable. In order to get it to detect in these rare situations, please connect the card reader to a USB 20Gbps or 10Gbps port and/or use a different USB cable, rather than Thunderbolt or USB4 40Gbps.

Q. Will this card reader function with USB Type-A hosts?

A. Yes, but an adapter or appropriate cable is required. Performance may be impacted by the host port specifications.



FOR HELP, COMMENTS, QUESTIONS OR CONCERNS
PLEASE CONTACT OUR TECH SUPPORT TEAM VIA OUR WEBSITE
WWW.SABRENT.COM